

SBS-804060

2500mAh

The SBS 804060-2500 is a 3.7V, 2500mAh Li-Polymer rechargeable battery pack in a 1S1P configuration. It features a built-in protection circuit that safeguards the battery against deep-discharging, over-charging, and short circuits

Electrical Characteristics:

Rated Capacity	2500mAh
Nominal Voltage	3.7 V
Max Continuous Charge Current	1250mA (0.5c)
Max Continuous Discharge Current	1250mA (0.5c)
Over-charge Protection Voltage	4.2V
Over-discharge Protection Voltage	2.4V
Over-current Protection for Discharge	6.5A
Short Circuit Protection	YES
Discharge Temperature	-20 ~ 60°C
Charge Temperature	0 ~ 45°C
Typical weight	41gm
Connector	JST PHR-2

Drawing of battery pack:

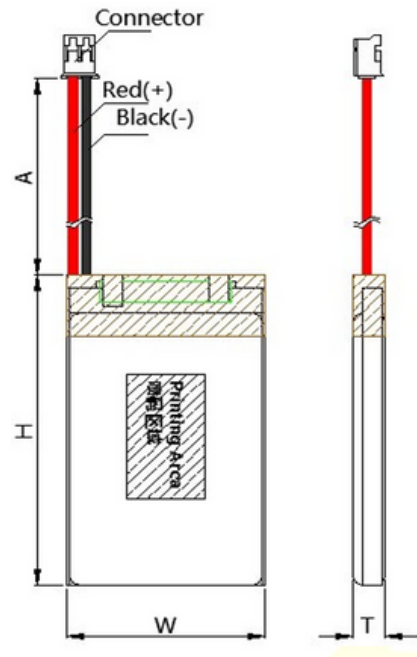

Dimensions of battery pack:

	Symbol	Size in mm
Thickness	T	8.2mm
Width	W	40.3mm
Height	H	53mm
Wire	A	100± 3 mm

Typical Applications:

- Telematics
- Medical Devices
- Robots
- Wearable Devices
- IOT Devices